



PRODUCT DESCRIPTION

Model Number	AV-GPS
Model Number	AV-GPS
Market	Aviation

The RAMI model AV-GPS is a permanently mounted external aircraft antenna designed for use with GPS receivers which provide +5 volts DC on their antenna connector. It is an active (amplified) antenna providing an average of 26 dB gain over a passive (non-amplified) antenna. The antenna is designed to operate at speeds up to 350 mph and altitudes up to 50,000 ft. It has a drag force of 0.18 lb @ 250 mph. (Not FAA TSO'd)

PRODUCT SPECIFICATIONS

Application	GPS Navigation
Frequency	1575 \pm 2 MHz
Impedance	50 Ohms Nominal
VSWR	1.2:1 Typical
Connector	"BNC" Female
Max Weight	0.5 lb
Max Height	0.75"
Gain	26 dBic \pm 2 dB
DC Power Requirement	+5 \pm 0.5 VDC @ 20mA Max
Not FAA TSO'd	

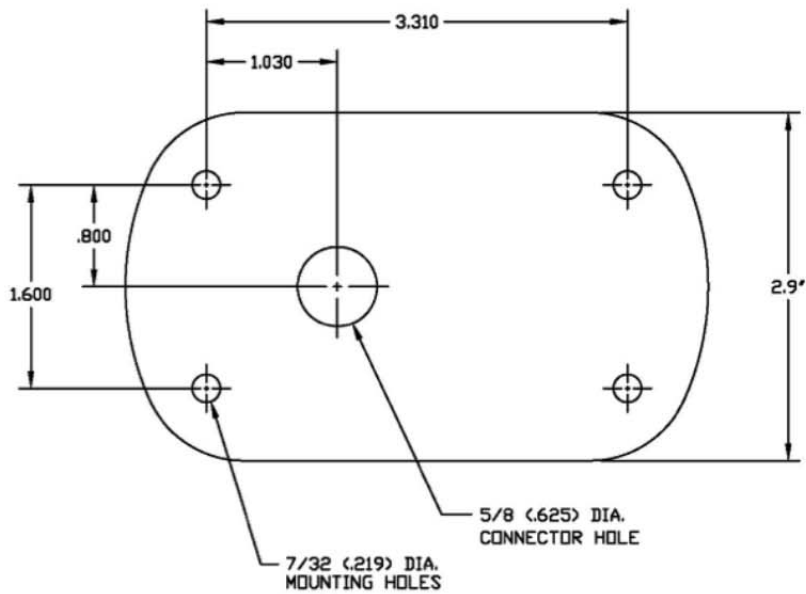
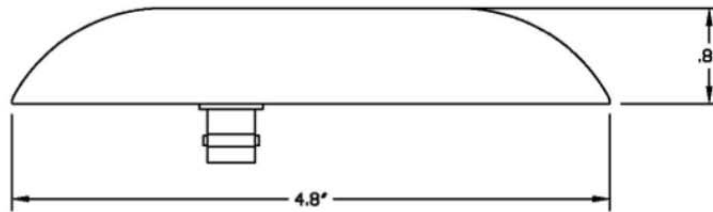

MOUNTING INFORMATION

(not to scale)